

Model FT-N032 Particulate Respirator N95

User Instructions
(Keep insert for reference)

Rev. A
6/1/2010

 **Warning**

This respirator helps protect against certain particles. **Misuse may result in sickness or death.** For proper use, see supervisor, *User Instructions*, or call +86-512-65586028 / 65586038

Company Name: Suzhou Fangtian Industries Co., Ltd.
Address: Xiehe Building, No.158 Jinmen Road, Suzhou City, Jiangsu, P. R. China
Fax: +86-512-65586018
E-mail: ftfire@pub.yc.jsinfo.net, ftfire@126.com
<http://www.chinamasks.com/>

USE LIMITATIONS:

- Do **NOT** use the respirator or enter or stay in a contaminated area under the following circumstances:
 - Atmosphere contains less than 19.5% oxygen
 - Atmosphere contains oil aerosols if using N protection class respirator
 - For protection against gases or vapors
 - Contaminants or their concentrations are unknown or immediately dangerous to life or health
 - Concentrations or contaminants exceed maximum use concentrations in applicable OSHA standards or applicable government regulations or 10 times the PEL (Permissible Exposure Limit), whichever is lower
 - For sandblasting, paint-spray operations, asbestos
- Do **NOT** modify or misuse the respirator.
- Do **NOT** use the respirator with beards or other facial hair that interferes with direct contact between the face and the edge of the respirator, or any other conditions that may prevent a good face-seal.

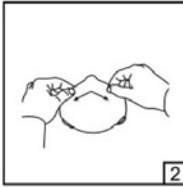
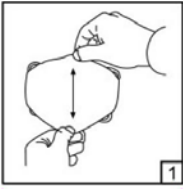

WARNING:

This respirator helps protect against certain contaminants. It may not eliminate the risk of contracting disease or infection. **Misuse may result in sickness or death.** Materials which may come into contact with the wearer's skin could cause allergic reactions to susceptible individuals.

FOR MORE INFORMATION or assistance please contact with Manufacturer.

FITTING INSTRUCTIONS

Follow these instructions each time respirator is worn.

- Separate the respirator so that it is fully open.
- Bend the nosepiece so that the respirator forms a cup
- Position the bottom edge of the respirator under your chin and bring the headbands over your head.
- Position the lower headband around the back of your neck. Position the top headband across the crown of your head.
- Pull the top straps back to adjust for a comfortable fit.
- Press the nosepiece firmly across the bridge of your nose so that the nosepiece conforms to your facial contours
- Fit-check the face-seal as follows:
 - Place both hands over the respirator without disturbing its position.
 - If the respirator is not fitted with an exhalation valve, exhale sharply.
 - If the respirator is fitted with an exhalation valve, inhale sharply (a negative pressure should be felt inside the respirator).
 - If you detect air-leaks, readjust the head straps and/or the position.



WARNING: If you cannot achieve satisfactory fit, do NOT enter the contaminated area. See your Supervisor.

USE INSTRUCTIONS:

- Failure to follow all instructions and limitations concerning the use of the respirator and/or failure to wear the respirator for the whole duration of exposure to contaminants can seriously reduce the performance characteristics of the respirator and lead to illness, injury or death.
- Before use, the wearer must first be trained by the employer in the correct use of the respirator in accordance with applicable safety and health standards.
- OSHA standards including 29CFR1910.134(e) (5) and CSA standard Z94.4-93 require that the wearer be fit-tested.
- Discard the respirator and replace with a new one if:
 - Excessive clogging of the respirator causes breathing difficulty.
 - The respirator becomes damaged.
- Leave the contaminated area if dizziness, irritation or other distress occurs.

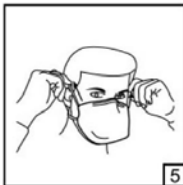

Different Features for Each Model:

| Model | Style | Valve | Protection level |
|---------|--------|-------|------------------|
| FT-N032 | Folded | None | N95 |
| FT-N005 | Cup | None | N95 |
| FT-N010 | Cup | None | N95 |



Suzhou Fangtian Industries Co., Ltd.
Xiehe Building, No.158 Jinmen Road,
Suzhou City, Jiangsu, P. R. China
TEL :+86-512-65586028 FAX : +86-512-65586018

THIS RESPIRATOR IS APPROVED ONLY IN THE FOLLOWING CONFIGURATION:

| TC- | Protection ¹ | Respirator | Cautions and Limitations ² |
|---------------|-------------------------|------------|---------------------------------------|
| | | FT-N032 | |
| 84A-SFIN032Ba | N95 | X | ABCJMNOP |

1. Protection

N95 - Particulate Filter (95% filter efficiency level)
Effective against particulate aerosols free of oil;
time use restrictions may apply

2. Cautions and Limitations

- A - Not for use in atmospheres containing less than 19.5% oxygen.
- B - Not for use in atmospheres immediately dangerous to life or health.
- C - Do not exceed maximum use concentrations established by regulatory standards.
- J - Failure to properly use and maintain this product could result in injury or death.
- M - All approved respirators shall be selected, fitted, used, and maintained in accordance with MSHA, OSHA and other applicable regulations.
- N - Never substitute, modify, add, or omit parts. Use only exact replacement parts in the configuration as specified by the manufacturer.
- O - Refer to users instructions, and/or maintenance manuals for information on use and maintenance of these respirators.
- P - NIOSH does not evaluate respirators for use as surgical masks.