

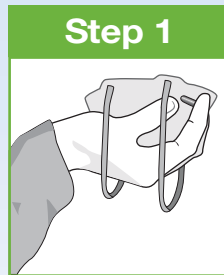

SPECTRA SHIELD™ 9500

Effective Respiratory Protection

Users shall follow the below fitting instructions each time the respirator is worn. This respirator is designed to be used as part of a respiratory protection program. Users of this respirator must be clean-shaven and free of any facial hair, which may interfere with seal area and fit of this respirator. The users should be fit tested with the same make, model, style, and size respirator as to be used.



Step 1

Hold the respirator in hand with nosepiece at your fingertips, allowing the head bands to hang freely below your hand.

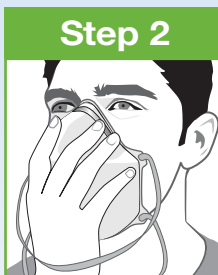

Step 2

Place under chin and press the respirator firmly against your face with the nosepiece on the bridge of your nose.

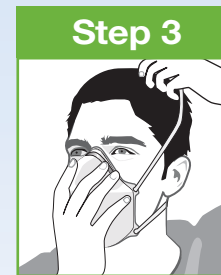

Step 3

Stretch and position the top band high on the back of your head. Stretch the bottom band over the head and position it below your ears.

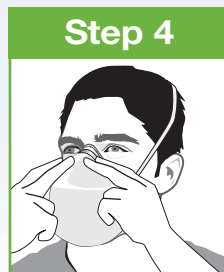

Step 4

Using both hands, mold the metal nosepiece to the shape of your nose.

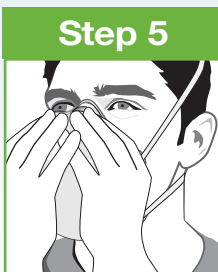

Step 5

To test fit, cup both hands over the respirator and exhale vigorously. If air flows around your nose, tighten the nosepiece. If air leaks around the edges of the respirator, reposition the straps.



Step 6

Repeat adjustments until the respirator is sealed properly. Entry into a contaminated area with an improperly fitting respirator may result in illness or death.

Made in the U.S.A.
Assembled in China.

***REMEMBER:**

Careful observance of these fitting instructions is an important step in safe respirator use.